

PLAN SHOWING THE PLOT HAVING AREA 09 DECIMAL MORE OR LESS INSIDE RS PLOT NO 1620 (PART), KHATIAN NO- 4938 INSIDE MOUZA- DIGNALA, JL NO- 43, PS- ANDAL UNDER ANDAL GRAM PANCHAYAT, DIST- PASCHIM BURDWAN, WEST BENGAL SHOWN AS-

NAME OF PROJECT- MAA SARADA APARTMENT

NAME OF OWNER- Koushik Mukherjee
 Geetanjali Park, Andal More
 Vill + PO + PS- Andal, Dist- Paschim Burdwan, West Bengal

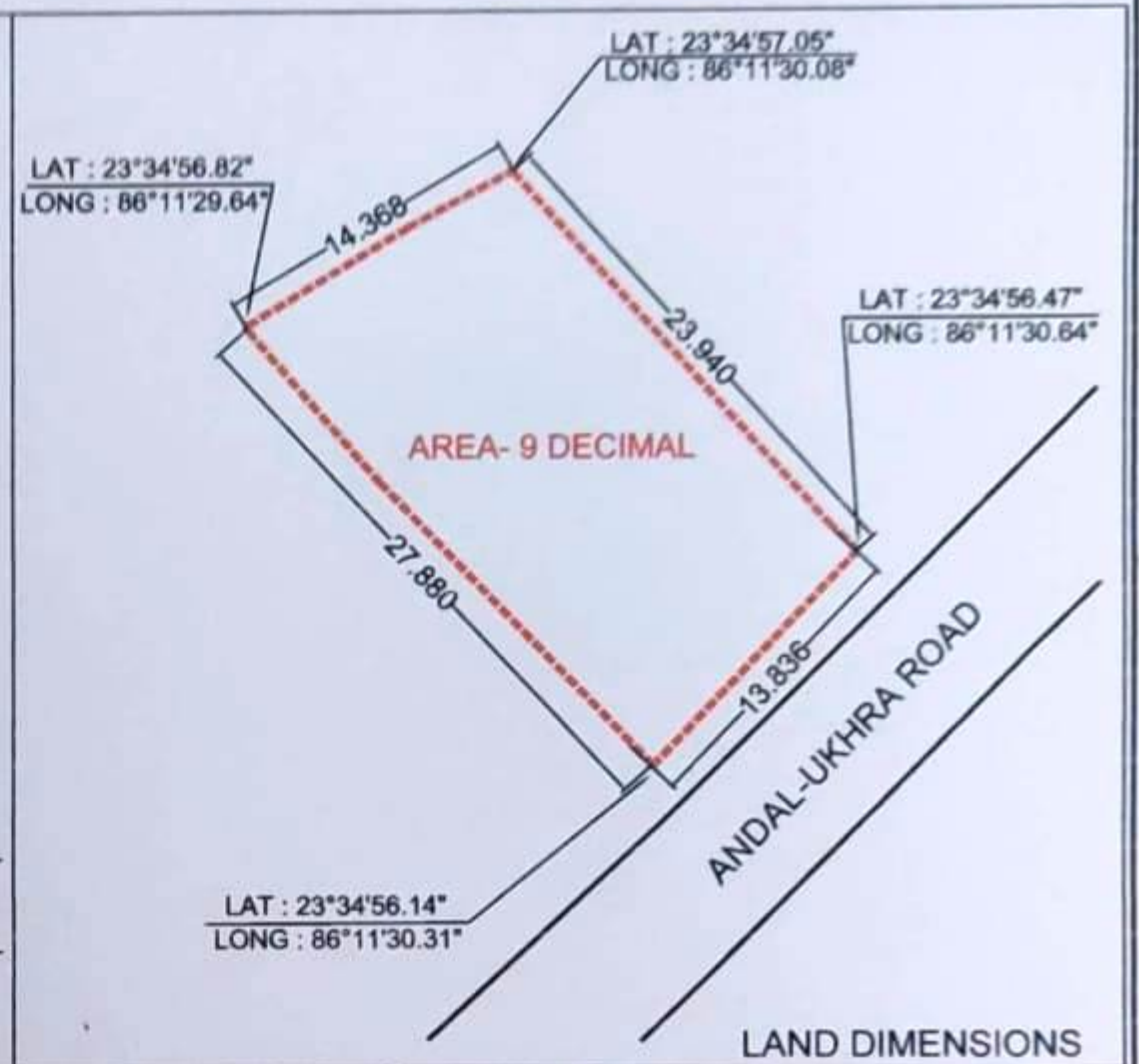
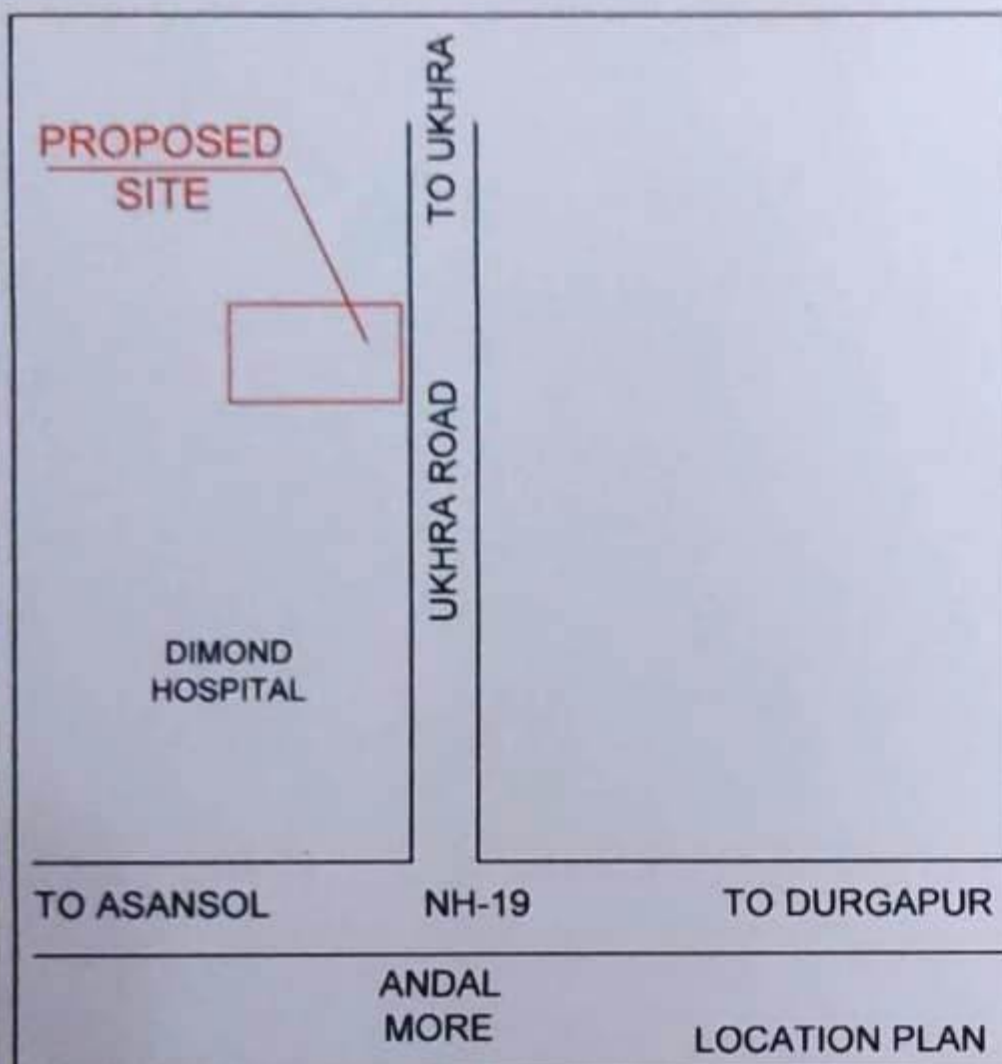

PREPARED BY-
 GLOBAL SURVEYORS
 REGD OFFICE- SEARSOLE BABUPARA
 P.O.- SEARSOLE RAJBARI,
 DIST.- PASCHIM BURDWAN (W.B)
 PH.- 94342 37231, 9833738281
 EMAIL:- info@globalsurveyors.org
 globalurveyors2001@yahoo.co.in
 WEBSITE:- www.globalsurveyors.org
 (AN ISO 9001:2015 CERTIFIED FIRM)

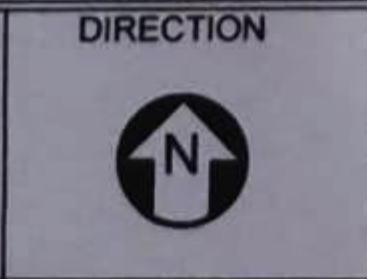

DRAWING NO- DATE
 GS/KM/ANDAL/2023/ 1 OF 1

SCALE

SIGNED & VERIFIED BY-

 GLOBAL SURVEYORS
 "PUSPANJALI" SEARSOLE BABU PARA
 P.O.-SEARSOLE RAJBARI,P.S.-RANIGANJ, PIN-713358
 DIST.-PASCHIM BARDHAMAN (W.B)